

CRIMPING TYPE COPPER TUBULAR CABLE TERMINAL ENDS - LIGHT DUTY

MATERIAL - E - COPPER
 FINISH - ELECTRO TINNED
 FEATURES - WITH INSPECTION HOLE AND BARREL ENDS ARE CHAMFERED FOR EASY ENTRY.

Cable Size SQ. mm	Stud Hole E	A	C	D	G	H	B	J	Product Code
1.5	4.2	1.8	3.7	8	4	5	5	16	ALD 1.5 - 4
	5.2	1.8	3.7	8	4	5	5	16	ALD 1.5 - 5
	6.5	1.8	3.7	10	5	6	5	18	ALD 1.5 - 6
2.5	4.2	2.4	4	8	4	5	7	18	ALD 2.5 - 4
	5.2	2.4	4	10	5	6	7	20	ALD 2.5 - 5
	6.5	2.4	4	10	5	6	7	20	ALD 2.5 - 6
	8.4	2.4	4	9	7	8	7	24	ALD 2.5-8
4	4.2	3.1	4.8	10	5	6	7	20	ALD 4 - 4
	5.2	3.1	4.8	10	5	6	7	20	ALD 4 - 5
	6.5	3.1	4.8	10	5	6	7	20	ALD 4 - 6
	8.2	3.1	4.8	12	7	8	7	24	ALD 4-8
6	5.2	3.8	5.5	10	5	6	9	23	ALD 6 - 5
	6.5	3.8	5.5	10	5	6	9	23	ALD 6 - 6
	8.2	3.8	5.5	12	6	9	9	27	ALD 6 - 8
	10.5	3.8	5.5	15	9	11	9	32	ALD 6-10
10	6.5	4.5	6.2	12	6	7	9	25	ALD 10 - 6
	8.2	4.2	6.2	12	6	9	9	27	ALD 10 - 8
	10.5	4.5	6.2	15	8.5	10.5	10	32	ALD 10 - 10
16	6.5	5.4	7.1	12	7	7	12	30	ALD 16 - 6
	8.2	5.4	7.1	12	7	9	12	32	ALD 16 - 8
	10.5	5.4	7.1	15	8	12	12	36	ALD 16 - 10
	12.7	5.4	7.1	16	8	12	12	36	ALD 16 - 12
20	8.4	6	7.7	12	7	9	12	32	ALD 20 - 8
25	6.5	6.8	8.8	13	6	7	14	30	ALD 25 - 6
	8.2	6.8	8.8	13	6	7	14	30	ALD 25 - 8
	10.5	6.8	8.8	16	9	11	14	37	ALD 25 - 10
	12.7	6.8	8.8	18	11	13	14	41	ALD 25 - 12
35	6.5	8	10	15	9	9	14	35	ALD 35 - 6
	8.4	8	10	15	9	9	14	35	ALD 35 - 8
	10.5	8	10	15	9	9	14	35	ALD 35 - 10
50	6.5	9.2	11.2	16	10	11	19	43	ALD 50 - 6
	8.4	9.2	11.2	16	10	11	19	43	ALD 50 - 8
	10.5	9.2	11.2	16	10	11	19	43	ALD 50 - 10
	12.7	9.2	11.2	16	10	11	19	43	ALD 50 - 12
70	8.4	11.5	13.8	20	12	13	21	50	ALD 70 - 8
	10.5	11.5	13.8	20	12	13	21	50	ALD 70 - 10
	12.7	11.5	13.8	20	12	13	21	50	ALD 70 - 12
95	8.4	12.8	15.6	23	13	13	23	55	ALD 95 - 8
	10.5	12.8	15.8	23	13	13	23	55	ALD 95 - 10
	12.7	12.8	15.6	23	13	13	23	55	ALD 95 - 12
	14.7	12.8	15.6	23	13	13	23	55	ALD 95 - 14
120	8.2	14.8	17.8	26	14	14	25	60	ALD 120 - 8
	10.5	14.8	17.8	26	14	14	25	60	ALD 120 - 10
	12.7	14.8	17.8	26	14	14	25	60	ALD 120 - 12
	17	14.8	17.8	26	14	14	25	60	ALD 120 - 17
150	8.4	16	19.6	28	16	16	30	69	ALD 150 - 8
	10.5	16	19.6	28	16	16	30	69	ALD 150 - 10
	12.7	16	19.6	28	16	16	30	69	ALD 150 - 12
	14.7	16	19.6	28	16	16	30	69	ALD 150 - 14

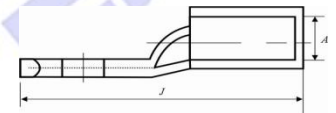
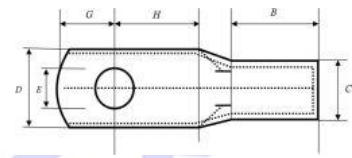

	17	16	19.6	28	16	16	30	69	ALD 150 - 17
185	10.5	18	22	32	17	17	36	78	ALD 185 - 10
	13	18	22	32	17	17	36	78	ALD 185 - 12
	14.7	18	22	32	17	17	36	78	ALD 185 - 14
	17	18	22	32	17	17	36	78	ALD 185 - 16
240	10.5	22	26	38	20	20	42	92	ALD 240 - 10
	13	22	26	38	20	20	42	92	ALD 240 - 12
	14.7	22	26	38	20	20	42	92	ALD 240 - 14
	17	22	26	38	20	20	42	92	ALD 240 - 16
	21	22	26	38	20	20	42	92	ALD 240 - 20
300	13	24	28.7	42	22	22	46	101	ALD 300 - 12
	14.7	24	28.7	42	22	22	46	101	ALD 300 - 14
	17	24	28.7	42	22	22	46	101	ALD 300 - 16
	21	24	28.7	42	22	22	46	101	ALD 300 - 20
400	14.7	28	33.2	49	26	26	49	114	ALD 400 - 14
	17	28	33.2	49	26	26	49	114	ALD 400 - 16
	21	28	33.2	49	26	26	49	114	ALD 400 - 20
500	14.7	30	36	53	28	28	53	124	ALD 500 - 14
	17	30	36	53	28	28	53	124	ALD 500 - 16
	21	30	36	53	28	28	53	124	ALD 500 - 20
630	17	35	41.5	61	33	33	61	144	ALD 630 - 16
	21	35	41.5	61	33	33	61	144	ALD 630 - 20

CRIMPING TYPE COPPER TUBULAR CABLE TERMINAL ENDS - BELL MOUTH

MATERIAL	- E - COPPER
FINISH	- ELECTRO TINNED
FEATURES	- BELL MOUTH ENTRY, WITH OR WITHOUT INSPECTION HOLE

For ordering BELL MOUTHED cable terminals prefix B to the product code nos. of Crimping Type Copper Tubular Cable Terminal ends.
For eg. AT 120 - 12 will be BAT 120 - 12.

